

Touch the screen to start

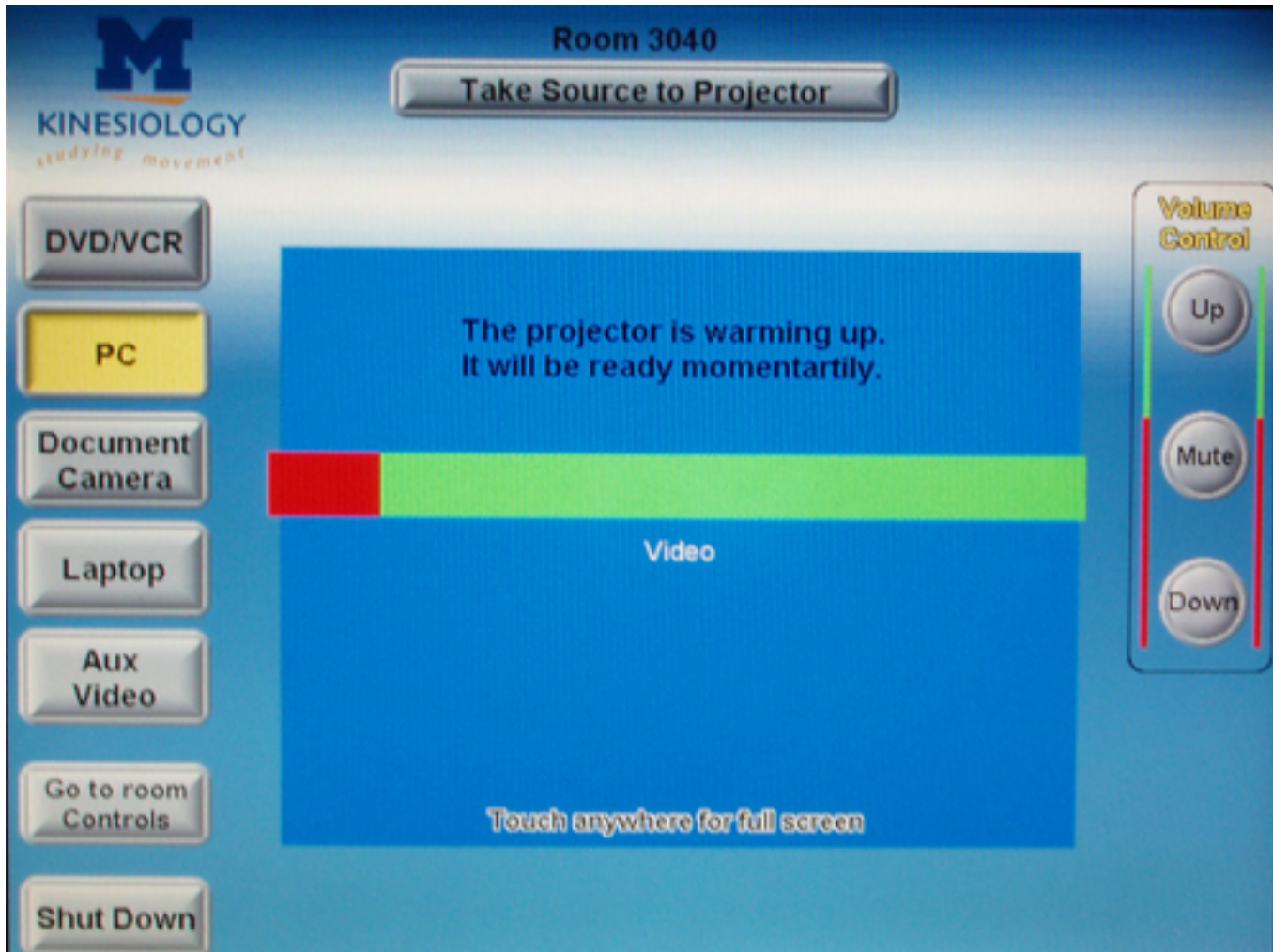

Problems? Call Kin-Help 4-4015

Screen may look like this at first. If the pc doesn't appear after a few minutes, open the cabinet and make sure it's turned on.

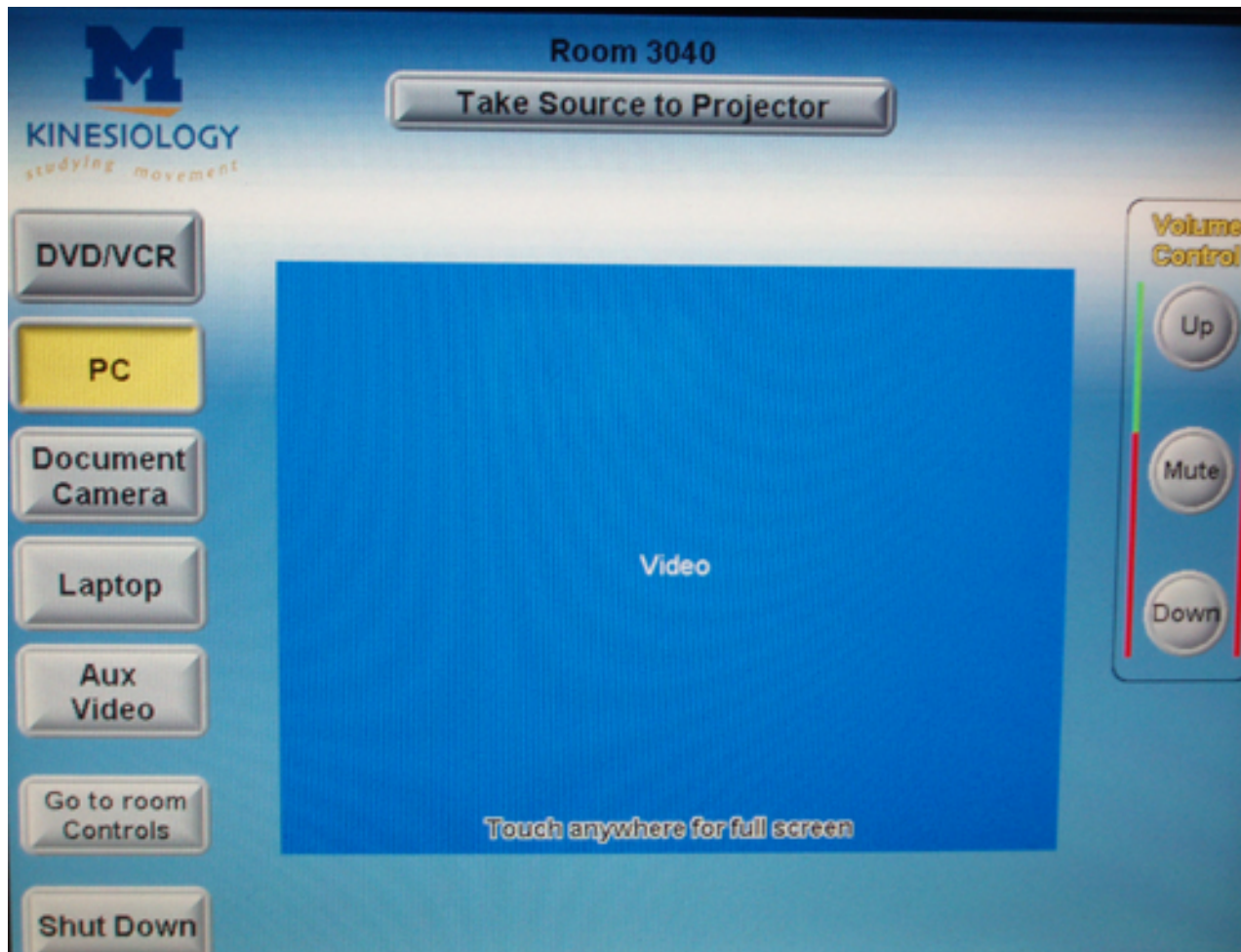

Problems? Call Kin-Help 4-4015

DVD/VCR controls

Press the button for the component you want.

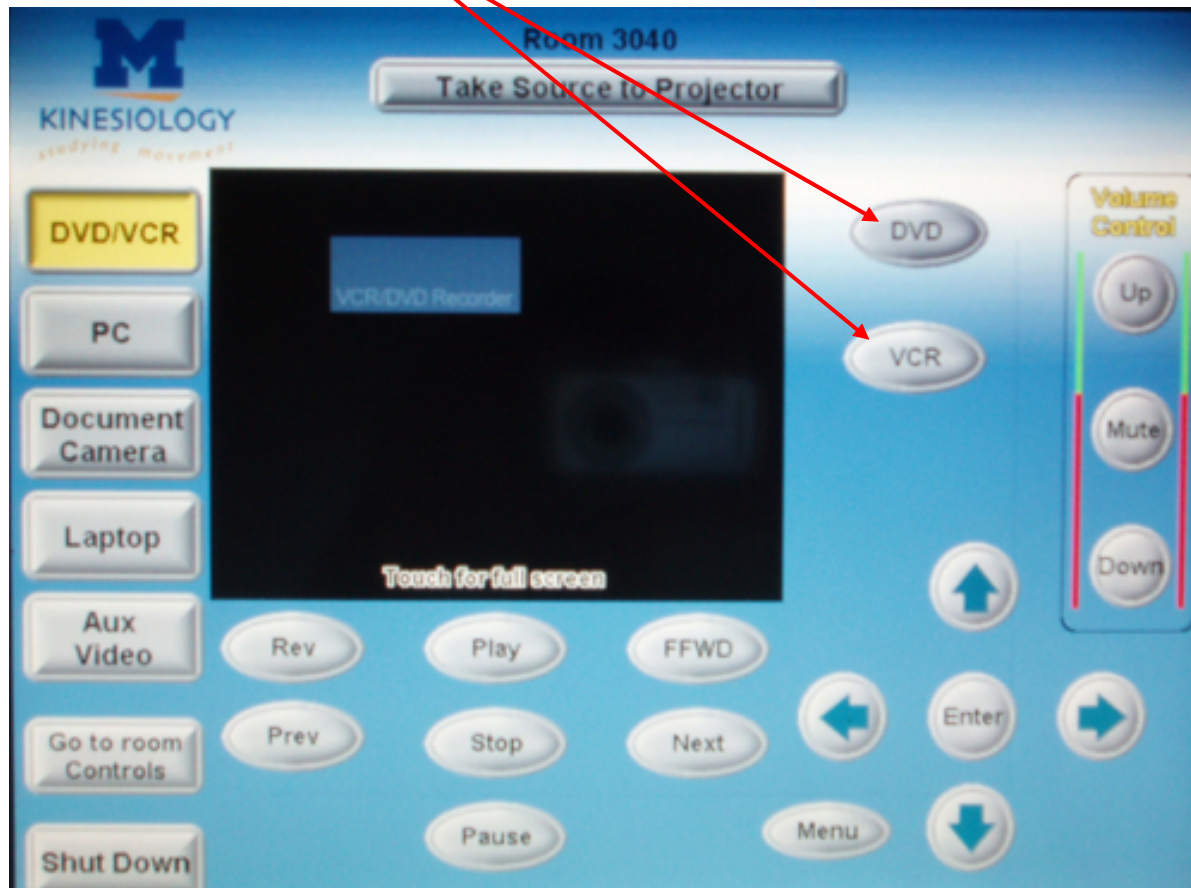

Problems? Call Kin-Help 4-4015

**For Pic Mute:
“Go to room controls”, then “Mute Proj”**

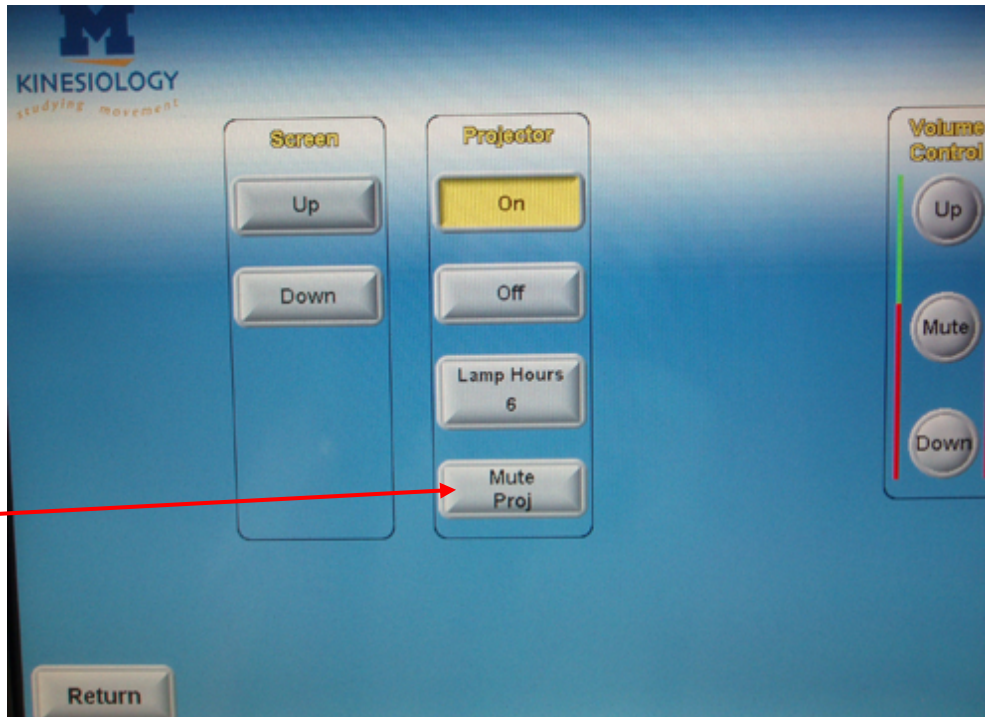
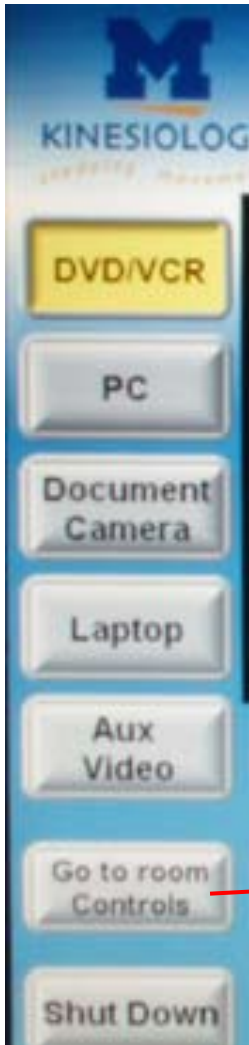

There's also a wall-mounted control for the screen

Problems? Call Kin-Help 4-4015